

MW-MLD-HE-1X-LENS170

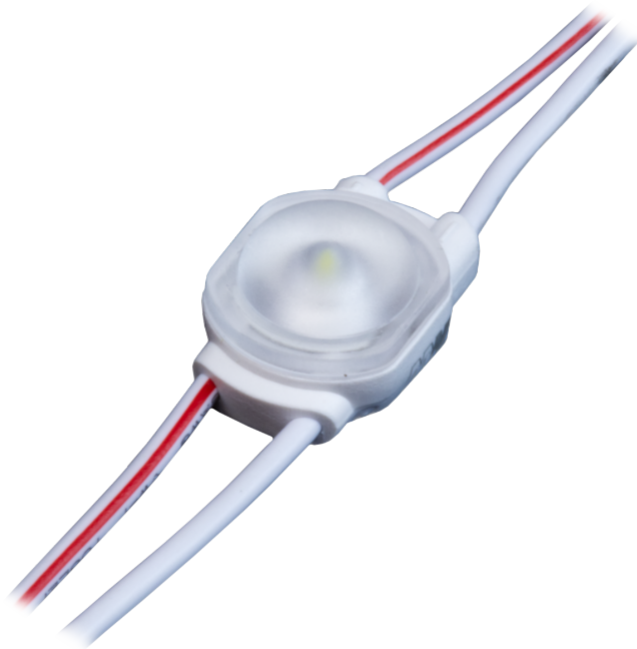

4-8 cm

3D letters, lightboxes



- luminous efficacy 153 lm/W
- premium quality
- built-in heat sink plate
- for indoor and outdoor use
- 40 pcs in chain

DIMENSIONS

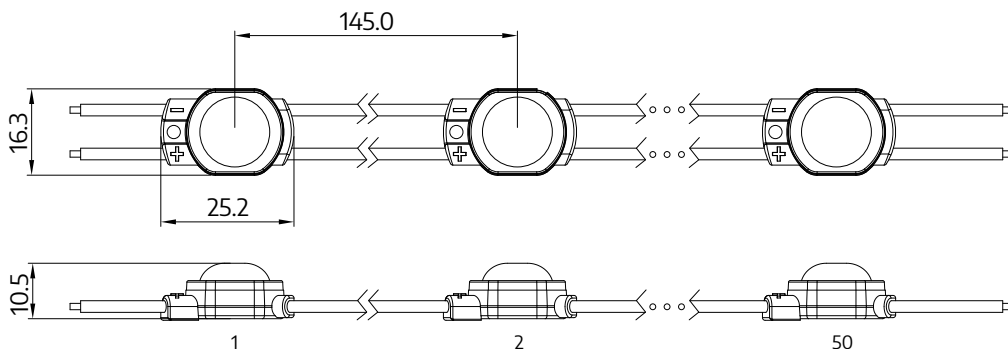

MW-MLD-HE-1X-LENS170



TECHNICAL SPECIFICATION

Parameter	Value
Rated voltage	12 V DC
Power consumption per module	0,36 W
Chain power consumption	14,4 W
Current consumption per module	30 mA
LED diodes	San'an led - 2835
Quantity of LEDs	1
Light color	X = W - white (7000K) X = WW - warm white (3000K) X = NW - neutral white (4000K) X = CW - cold white (10000K)
Flux	55 lm
Flux density	153 lm/W
Color rendering index CRI	≥70 (on request ≥80, ≥90, ≥95)
Beam angle	170°
Current stabilization	No
Dimming	Yes
Module dimensions (L × W × H)	25 × 16 × 11 mm
Cable length	120 mm
Number of modules in 1 m	6,9
Box weight	15 kg
Montage	Adhesive tape / mounting screw
Lifetime	L70B50 > 50000h
Working temperature	-25°C ... +55°C
IP protection	IP67
Warranty	7 years

MW-MLD-HE-1X-LENS170



CONNECTION DIAGRAM

One-side power input



Maximum number of modules 40 pcs

Two-side power input



Maximum number of modules 80 pcs

It is acceptable to connect multiple chains in parallel, as long as the power supply provides sufficient power.

BEAM ANGLE

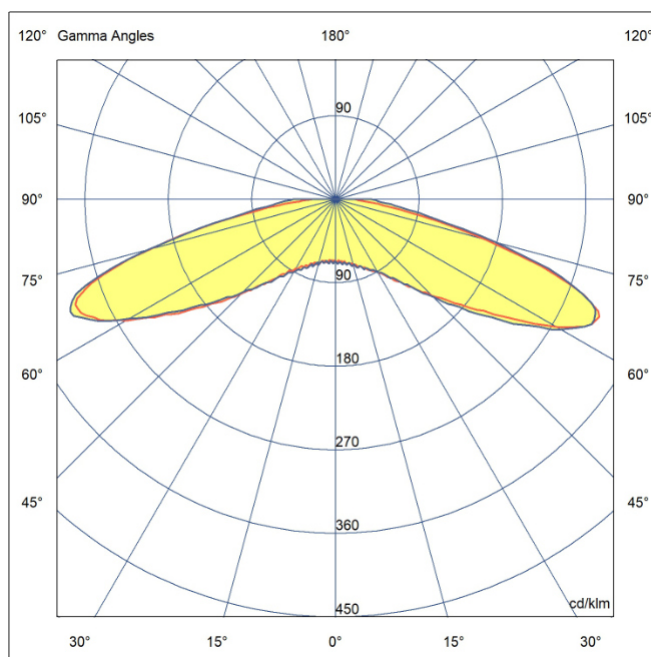

LIGHT COLOR / CCT

Abbreviation	Light color	CCT
WW	warm white	~3000K
NW	neutral white	~4000K
W	white	~7000K
CW	cold white	~10000K

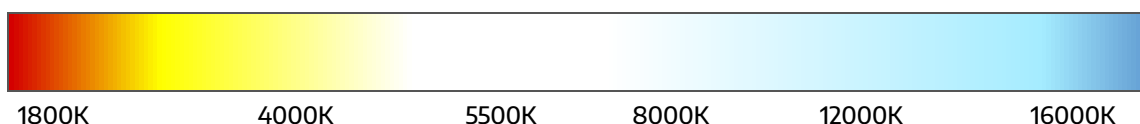

MW-MLD-HE-1X-LENS170



PACKING

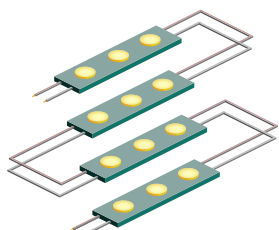

Chain
40 pcs



Bag
200 pcs

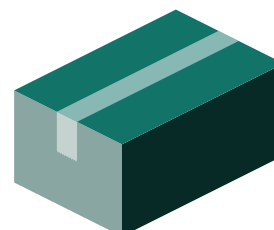

Box
2000 pcs